

Garden for Pollinators

with Kira Slepchenko

Start small, build and expand as you go!

Sunny, not windy

Group same plant together

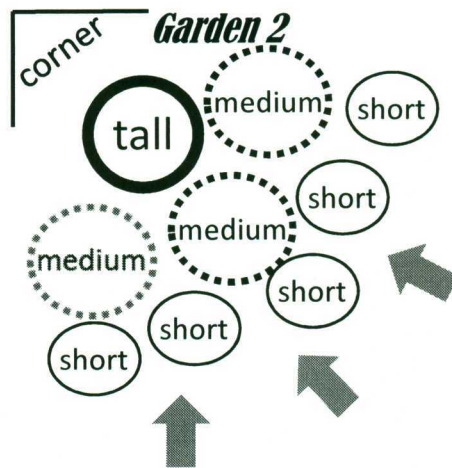
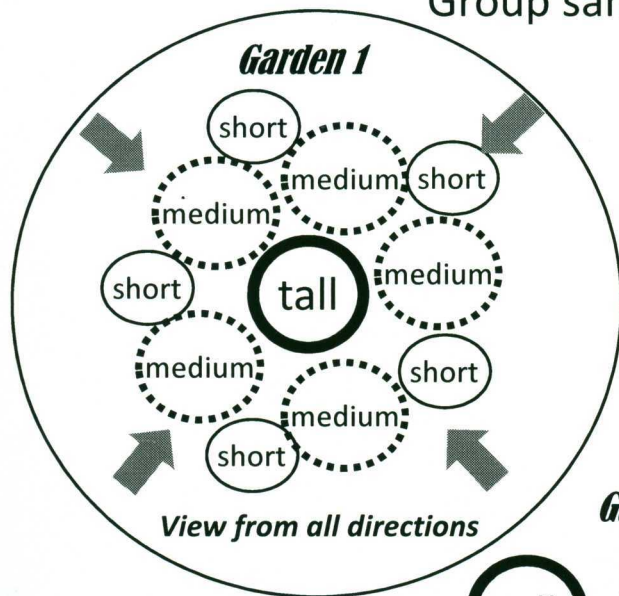

Garden 3

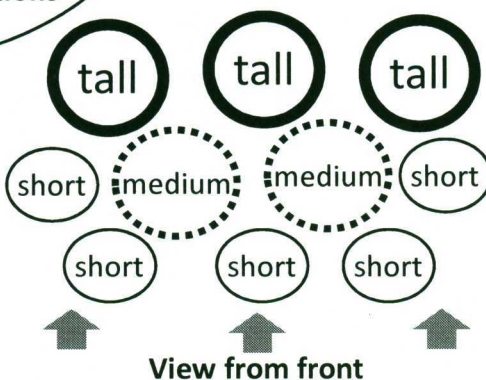

Be patient, observe and enjoy!!!

pot 1 (18-20 in)

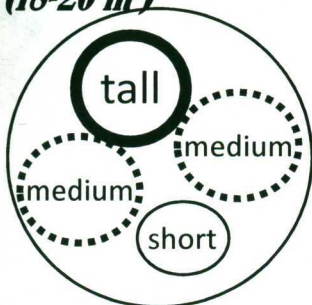

pot 2 (18-20 in)

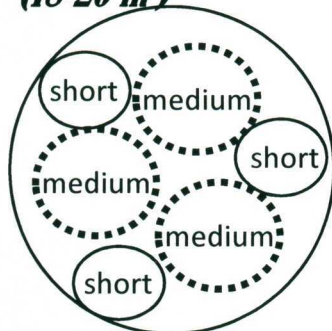

tall	medium	short
Joe Pie Weed	Bergamot	Allsum
Cosmos	Zinnias	Sage creeping
Milkweed (common)	Cock's comb	Nasturtium
Zebrina (French Hollyhock)	Cone flower	Parsley
Hollyhock	Black Eyed Susan	Clover
Sunflowers	Milkweed (butterfly weed)	Violets
Alfalfa	Borage	
Dill	Chicory	
Goldenrod	Calendula	
Aster	Columbine	
English Aster		
Swamp Mallow		
Ironweed		

Bold = easy to start from seeds

Plant listed plants among your vegetables and fruits...